

Serviced Office Space UK

1 Bartholomew Close

London EC1A 7BL

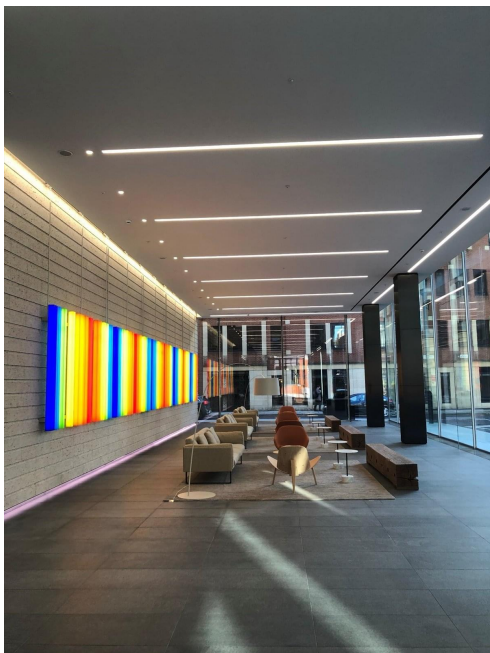

The workspace is situated in the heart of London, placing tenants and their teams in a well-connected and easily accessible location. This centre boasts excellent transport links. The centre is located close to Farringdon station. It enables quick access to the Elizabeth and Thameslink lines along with the Metropolitan, Circle and Hammersmith & City lines. Clients can enjoy local eateries serving a variety of cuisines and entertaining their guests. This building is a wonderland for all things digital – providing an ever-expanding hub of creatives with never-ending networking opportunities.

This centre is a great space that has been designed to meet the demands of any modern business. This centre has all leased space solutions equipped to cater to all the needs in a community where companies grow together. These spaces are designed to enhance the productivity of the team. This recently refurbished centre provides a great platform for any business to flourish with its cost-effective workplace solutions. The centre provides amenities like high-speed internet, parking space, meeting space, administrative support, and kitchen facilities. Many restaurants, cafes, shopping centres, and other local amenities are close to this centre.

transport links

Underground	Barbican
Train Station	Liverpool Street Station
Road Link	N/A
Airport	London City Airport

Leased Spaces

- **Price** : £10 pcm
- **Min Price** : £10 pcm
- **Min Size** : 1 sq ft
- **Max Size** : 180 sq ft
- **Total Size** : 19619 sq ft
- **Min Term** : 24 mnths
- **Max Term** : 36 mnths