

# Serviced Office Space UK

---

## Newcastle NE4 5TG

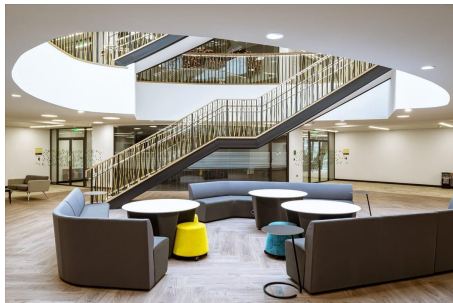

Just a seven-minute walk from St James Metro station in Newcastle's centre, this property is much more than serviced offices. It is the perfect place to house your business. Both this area and the wider Helix development are home to an innovative community that generates valuable networking opportunities and hosts regular business, community and social events. All of the amenities that Newcastle's bustling city centre has to offer are just a short walk away. With cafes, restaurants, shops and supermarkets nearby to enjoy on lunch breaks or after hours.

This building has an ecosystem brimming with innovative individuals from the UK's National Innovation Centre for the Ageing and the National Innovation Centre for Data, both hosted and funded by Newcastle University in partnership with UK Government. The dynamic community will enable the creation of a supportive ecosystem between the innovation centres and commercial organisations, focusing on either delivering new insights through data analytics or delivering new products and services, which help us age well and for longer. The award-winning building has become the first commercial building in the North East to be awarded the certification "Outstanding" by BREEAM, a rating reserved for only the top 1% of new UK non-domestic buildings. The office space is specifically for our companies in the Age-tech and Data sector. Our Grade A workspaces offer flexible terms, super-fast broadband and an on-site café, so you will always find the space to work collaboratively in these innovative surroundings. The dynamic structure is there to give you a space to thrive. With a supportive centre team, bespoke facilities and a vibrant community full of collaboration opportunities, you are sure to find success at this location.

### transport links

<b>Underground</b>	St James
<b>Train Station</b>	Newcastle
<b>Road Link</b>	N/A
<b>Airport</b>	Newcastle Airport

### Serviced Offices

---

- **Price** : £207 pcm
- **Min Price** : £207 pcm
- **Min Size** : 1 wkstns
- **Max Size** : 48 wkstns
- **Total Size** : 93 wkstns
- **Min Term** : 3 mnths
- **Max Term** : 12 mnths