

Serviced Office Space UK

7 Corsican Square

London E3 3YD

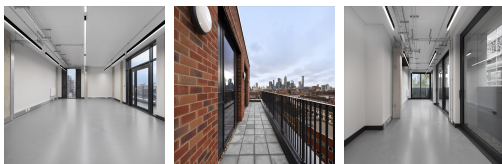

Situated in the heart of Bow a stones throw away from the City of London placing you and your team close to the heart of the city whilst avoiding the hustle and bustle. Devons Road light rail station is located on the doorstep of the building. Bromley-By-Bow Station can be reached in just eight-minutes on foot. You can also hop on the 108 bus just one-minute away at Devons Road Station Stop. A number of useful amenities including shops, pubs, and cafes are located within walking distance. The Widows Son is located just next door to the office - perfect for a drink with colleagues after work.

This location comprises 90 offices spanning over six-floors which benefit from an abundance of natural light, high ceilings, and industrial features. This flexible office space provides you with the freedom to make the space your own and you will be able to pick the layout, furniture and décor of your choice. Members have access to a wealth of useful and meaningful amenities including; 24 hour access, an on-site cafe, meeting rooms, showering facilities, cycling racks, and a staffed reception. In addition, a centre manager is available to ensure your working week runs smoothly. Connect and collaborate at this state-of-the-art location.

transport links

Underground	Bromley-By-Bow Station
Train Station	Liverpool Street Station
Road Link	N/A
Airport	London City Airport

Serviced Offices

- **Price** : Â£500 pcm
- **Min Price** : Â£500 pcm
- **Min Size** : 1 wkstns
- **Max Size** : 23 wkstns
- **Min Term** : 6 mnths
- **Max Term** : 24 mnths