

# Serviced Office Space UK

## 21 Farncombe Street

Godalming GU7 3AY



This business centre is situated a 20 minute walk into Godalming centre. The work space is easily accessed via public transport, Farncombe Train Station is located just a quick two minute walk away. The beautiful Broadwater Park is located an eight minute walk from the work centre, perfect for a summer lunch spot. There are many great local amenities in close proximity to the work centre, such as a Co-op and a variety of cafes. The work centre is nearby to great road links and the office space provides one parking space per unit.

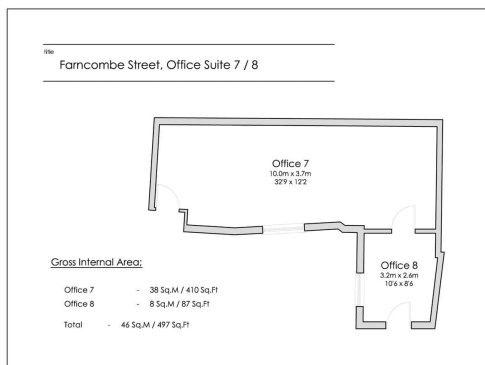

This business centre has two vacant office suites available. The office suites range in size from 90 Sq Ft to 410 Sq Ft and can be let individually or together as an open planned office with an adjoining private office or meeting room (totalling approx. 500 sqft). The building has great facilities, including an on-site management team who are on-hand to support your business, 24 hour access, communal kitchen facilities and CCTV to give you that extra peace of mind. The work centre offers one parking space per unit. The business centre is situated just two minutes from a mainline railway station.

### transport links

Underground	N/A
Train Station	Farncombe
Road Link	N/A
Airport	Farnborough Airport

### Serviced Offices

- **Price** : Â£200 pcm
- **Min Price** : Â£200 pcm
- **Min Size** : 3 wkstns
- **Max Size** : 6 wkstns
- **Total Size** : 35 wkstns