

Serviced Office Space UK

Wood Lane

Iver SL0 0LB

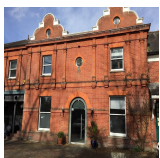
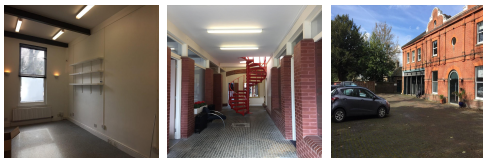

This office space is located in a rural part of Iver, just under four-miles from Slough and just 19-miles from central London. London Heathrow airport is located 5.2-miles away and provides excellent travel links to cities both within the UK and outside of the UK. Iver town centre provides many local amenities including a post office and The Swan at Iver hotel along with restaurants, pubs and shops. Iver is around one-mile away and from here you can get public transport to the surrounding areas. Bus stops can be found 0.5-miles away with many buses available to take you to neighbouring areas. Langley train station is also just 1.2-miles away, therefore this location is well connected to the surrounding villages, towns and cities.

Leased office space available in a beautiful period building within secure rural grounds located in Iver, Buckinghamshire. There is gated entry into a private rural estate which offers a unique setting for your office base. The suites available are unfurnished and can accommodate from two to four people and are offered on a 12-month lease. Gas, electricity and water are included in the rental charge and there is access to a shared kitchen. The communal areas are cleaned weekly and the building is very well looked after, providing a clean and attractive working environment. Storage space is also available on site for an additional charge. Parking is available through the gated access entryway.

transport links

Underground	Uxbridge Underground Station
Train Station	Langley
Road Link	N/A
Airport	Heathrow Airport

Leased Spaces

- **Min Size** : 1 sq ft
- **Max Size** : 60 sq ft
- **Total Size** : 3300 sq ft
- **Min Term** : 3 mnths
- **Max Term** : 99 mnths