

Serviced Office Space UK

London EC2A 2BS

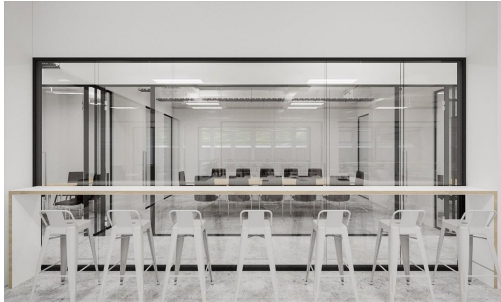

This workspace is just a five-minute walk from Liverpool Street Station and the Moorgate Underground Station entrance. The space is next to Finsbury Square in the very heart of the city centre. The area is comprised of a multitude of corporate companies such as the Google Campus, Tech City, Ideal London and Microsoft Ventures. It is a great place to start a business in a space with all the hustle and bustle of the city. Explore a range of world-famous landmarks and attractions that London has to offer.



This centre is in a five-storey building. It is just five minutes from Liverpool Street Station, covering a total area of 70,000 square feet. The space provides a multitude of options for both private office space as well as an area of over 23,000 square feet, dedicated to coworking with 200 workstations. Tenants of the space have access to the on-site gym and shower rooms as well as the in-house bars and cafeterias. This centre is a hub for innovation and gives tenants exclusive access to investor events and access to the centre-run incubation programmes. The space also gives tenants access to in-house mentoring and start-up services.

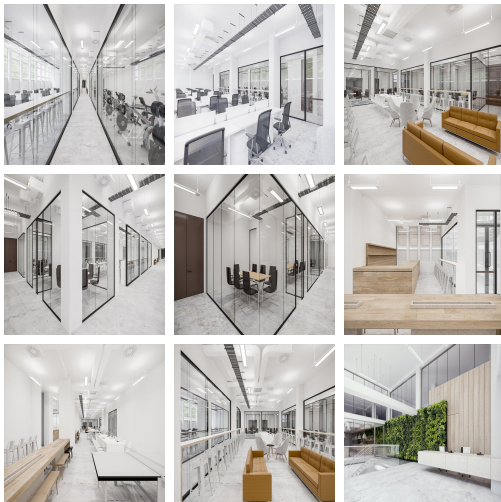

transport links

Underground	Liverpool Street
Train Station	Liverpool Street Station
Road Link	N/A
Airport	London City Airport

Coworking Spaces

- **Price** : £400 pcm
- **Min Price** : £400 pcm
- **Total Size** : 70 wkstns
- **Min Term** : 1 mnths
- **Max Term** : 36 mnths