

Serviced Office Space UK

332 Ladbroke Grove

London W10 5AD

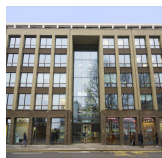
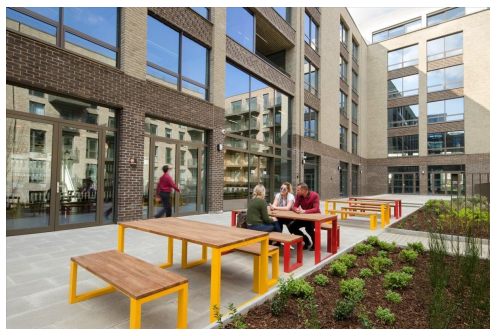

Situated in a prime location in London, surrounding the space are many facilities like eateries, where tenants can enjoy a lunch break or an evening of entertaining clients. Commuting to work is also easy. This centre is conveniently located and boasts excellent transport links as well. The surrounding area offers a wide range of eateries and amenities like banks and retail shops, providing tenants with everything at their doorstep. The centre is accessible from almost every transport link, placing tenants and their teams in a well-connected and easily accessible location.

The refined design and stunning landmark architecture are locally renowned as a commercially significant business establishment incorporating a neutral palette, international style, and industrial materials to create an elegant and fun workspace. Spacious, fully-furnished offices offer a team somewhere to work comfortably, where members can move in and get started - no need for time wasted setting up various desks. This state-of-the-art centre provides an excellent platform for any business to flourish with its cost-effective workplace solutions. This building is a wonderland for all things digital - providing an ever-expanding hub of creatives with never-ending networking opportunities.

transport links

Underground	Ladbroke Grove
Train Station	Kensal Green
Road Link	N/A
Airport	Heathrow Airport

Serviced Offices

- **Price** : £320 pcm
- **Min Price** : £320 pcm
- **Min Size** : 1 wkstns
- **Max Size** : 122 wkstns
- **Total Size** : 200 wkstns
- **Min Term** : 3 mnths
- **Max Term** : 36 mnths