

Serviced Office Space UK

Manchester M1 4HA

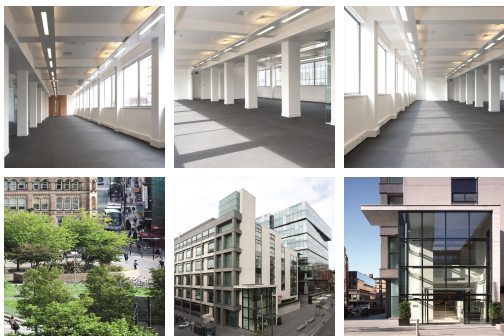

There are plenty of convenient travel links with Metrolink tram stops and the Piccadilly bus terminal on your doorstep and Manchester Piccadilly train station is within 5 minutes' walking distance. Surrounding the space are fantastic places to eat and drink, some of the best Manchester has to offer, including The Alchemist, The Grill on New York Street and The Bank. There are also several hotels in the area, including the Radisson Blu, Mercure Manchester Piccadilly Hotel and ABode Manchester. These are perfect for visitors who can arrive at the easily accessible Manchester Airport.

Located on New York Street in Manchester city centre, this imposing property was previously home to Manchester's telephone exchange and, with its large office floor plates, provides an ideal office building to transform into contemporary office space. The building has been completely refurbished and transformed both internally and externally to create over 40,000 sq ft of brand new offices over five floors. These offices come with the added benefit of on-site car-parking and a dedicated customer service team to manage the reception area and ensure the smooth operation of the building, leaving you free to run your business.

transport links

Underground	N/A
Train Station	St. Peters Square Metrolink
Road Link	N/A
Airport	City Airport Ltd

Leased Spaces

- **Min Size** : 1 sq ft
- **Max Size** : 50 sq ft
- **Min Term** : 36 mnths
- **Max Term** : 60 mnths