

Serviced Office Space UK

Capital House

London NW1 5DH

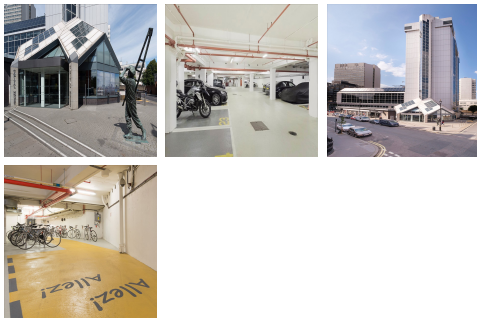
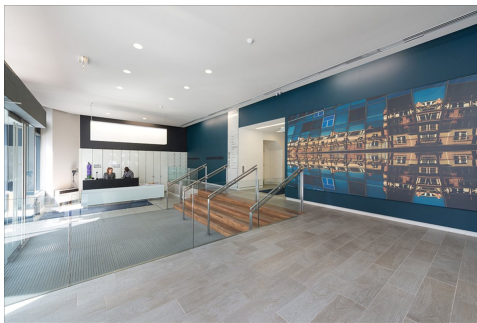

Welcome to Iconomy, where our mission is simple, to provide budget-conscious entrepreneurs, startups, and established businesses with a flexible, professional office environment where they can thrive without compromising on quality or service. Founded in the bustling heart of London and powered by our parent One Avenue Group, our journey began with a simple yet powerful vision: to redefine the serviced office experience by making it accessible and affordable for all. We have proudly done just that with the launch of Capital House strategically located in the bustling neighbourhood of Marylebone.

Capital House is located in between Marylebone and Paddington, a stones-throw away from Edgware Tube Station. Iconomy's mission is to provide affordable office space without compromising on the quality of service. We offer a wide range of rewarding services tailored to your business needs, striving to define a new era of elevated affordability in flexible workspace. At the heart of Iconomy's philosophy is accessibility. They believe that everyone deserves access to a conducive work environment that fosters productivity and growth, irrespective of their budget constraints. Capital House exemplifies this commitment by offering flexible lease options, state-of-the-art facilities, and a prime location that facilitates networking and collaboration.

transport links

Underground	Edgware Road
Train Station	Victoria Station
Road Link	N/A
Airport	London City Airport

Serviced Offices

- **Price** : Â£399 pcm
- **Min Price** : Â£399 pcm
- **Min Size** : 4 wkstns
- **Max Size** : 117 wkstns
- **Total Size** : 304 wkstns
- **Min Term** : 3 mnths
- **Max Term** : 12 mnths