

Serviced Office Space UK

4-5 Victoria Square

Wolverhampton WV1 1LD

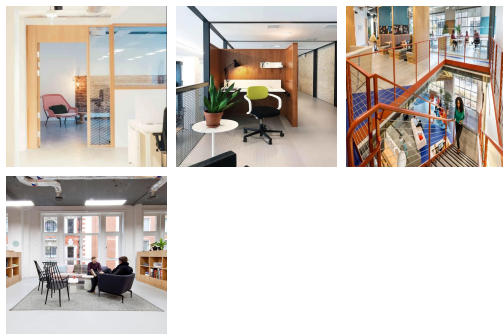
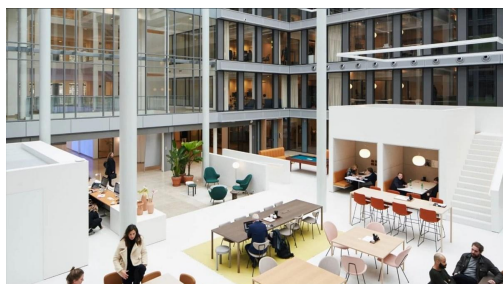

Strategically located in Wolverhampton's new Central Business District, right next to the city's transport interchange, i11 becomes the perfect place to level up any brand. Maximize opportunities in Wolverhampton's hottest destination and bring out the best in a beautifully designed office. When the team is needed, clients and partners can be brought together using the convenient transport links around the office. Wolverhampton Interchange is just a one-minute walk from the doorstep, offering unrivalled access to local bus, rail, and tram routes.

Elevate the business with flexible office space on Victoria Square. Achieve peak performance with premium workspace in Wolverhampton. Find inspiration within a stylish office furnished for comfort and tailored to meet needs. Draw in new business from a landmark building situated in a high footfall area and network with fellow professionals in shared office space. Connect with skilled individuals in dedicated coworking areas, fostering collaboration in a friendly atmosphere. When presenting or pitching, easily book a fully equipped meeting room using the convenient app and utilize the latest technology to ensure the gathering is a success.

transport links

Underground	N/A
Train Station	Wolverhampton
Road Link	N/A
Airport	Birmingham Airport

Virtual Office

- **Price** : Â£75 pcm
- **Min Price** : Â£75 pcm
- **Min Term** : 24 mnths
- **Max Term** : 999 mnths